

# NEXT ISLAND PROPERTIES

Changing the  
world



**"Alone we can do  
so little; together  
we can do so  
much."**

Helen Keller

- Helen Adams Keller (June 27, 1880 – June 1, 1968) was an American author, disability rights advocate, political activist and lecturer.



# Delivering suitable offers in to your investors



Right projects can  
help you to  
increase your  
reputation between  
your investors'  
networks



**1**

**More than 25+  
projects we  
deal with**

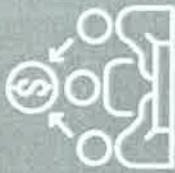

**2**

**We have met  
more than 200+  
investors in  
2022**



**3**

**100+ units got  
sold by our  
team**



**4**

**More than 15+  
international  
partners we  
work with**



**5**

**150 units get  
sold in North  
Cyprus per  
week**

04

# Kağan Semavi

My interest in real estate began after I completed my degree in Civil Engineering in 2011 and I started off my career as a Marketing Manager of a well-known internet company. Then I worked as a coordinator for a construction company. The founder of the Estate campus in 2018 I became a partner, broker, and director of Century 21 Island after great results we decided to have a new challenge at Keller Williams Northern Cyprus as partner, broker, and director.



# Mutlu Günen

I worked for 4 years at the Savannah Marriott Hotel in Georgia, USA. I returned to Northern Cyprus and worked as a Service Manager at Salamis Bay Conti Hotel. By evaluating the offer from Boray Estates in April 2011, I switched to the Real Estate Sector and worked as a broker in Era Time and Century 21 Island, the leading real estate offices of the island, which have been using global brands for a long time. Now I am the Founding Partner and Broker of Keller Williams Northern Cyprus.



# Volkan Sulugöz

I started my career in Turkey's leading companies as Efes and Hürriyet Emlak Field Sales, and Customer Satisfaction organizations working in managerial positions since 1999. With the management, training, development, planning, and customer satisfaction of the sales teams, I have achieved successes that increase the efficiency of the brands. I was the CEO of Century 21 Island and Now I am the CEO of Keller Williams Northern Cyprus

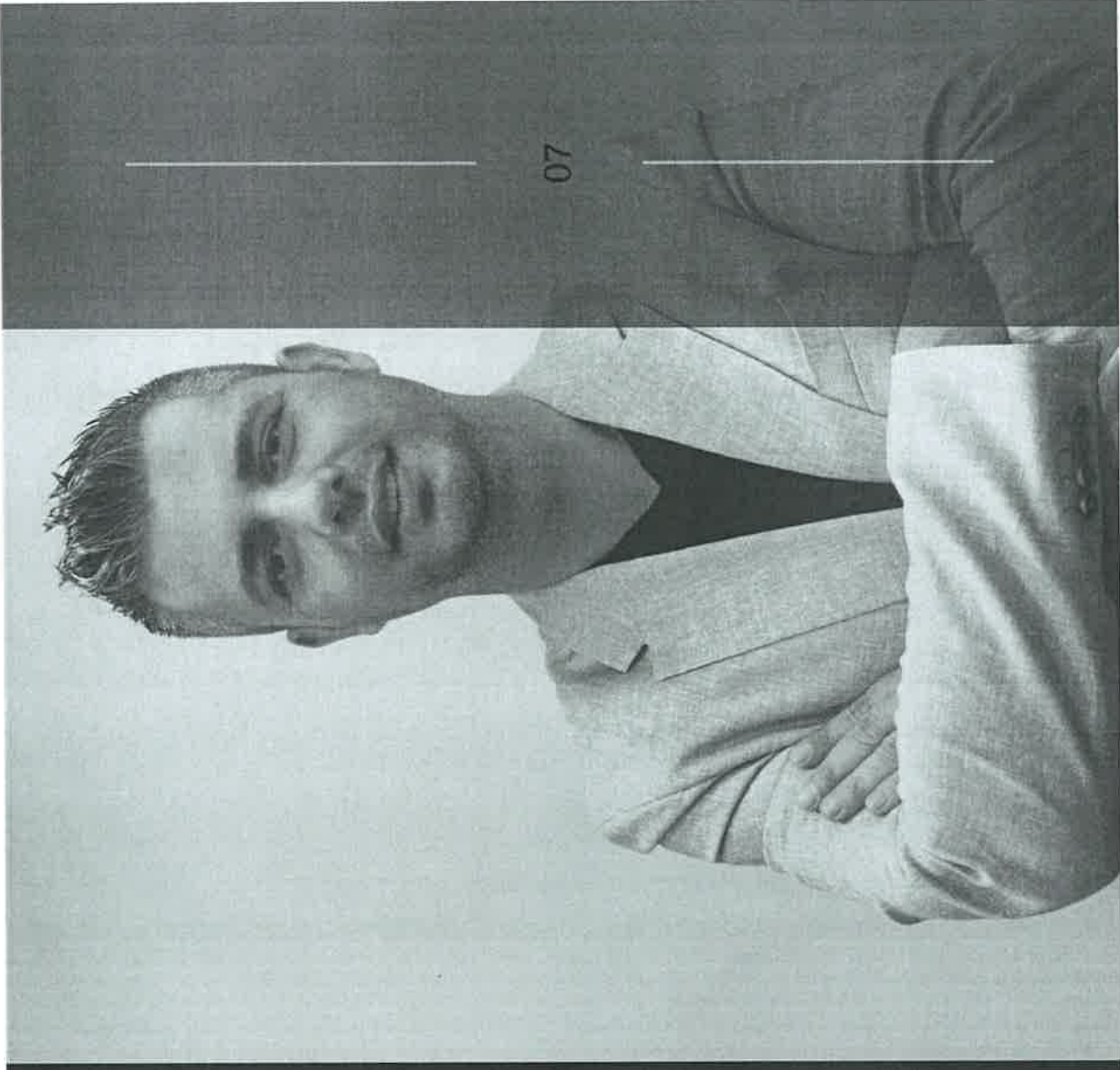

# Melis Atlıhan

I started my professional life as Dimes Fruit Juices Personnel and Administrative Affairs Chief, after working as Finance Manager at Tekmar and Customer Relations Manager at Kazancı Holding, I added Sales Manager with British American Tobacco - GLO Cyprus Social Selling to my human relations management experience that I developed. The real estate industry led me to Century 21 Island team leadership. Now I am the team leader at the Keller Williams Northern Cyprus office.



# Khaled Belfas

I was the founder and consultant since 2018 at Alyasin Group for student services in North Cyprus by dealing with partners around the world. Then I met the CEO of Century 21 Island Real Estate to improve my skills in projects and international relations in 2021. Now I moved with the same team to Keller Williams Northern Cyprus for new challenges

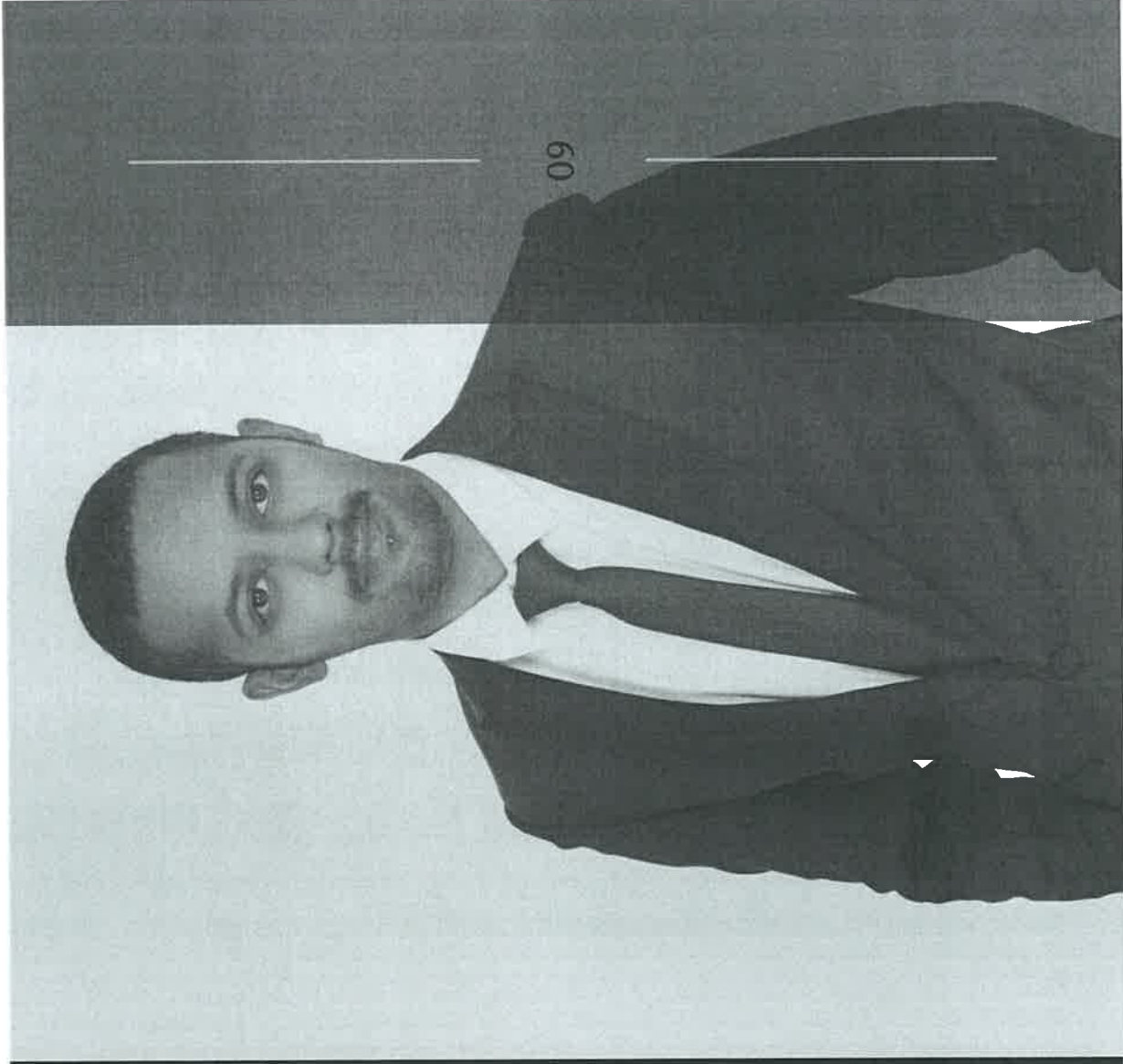

# Mariyam Sultanova

I graduated from the Psychology department at Girne American University in 2020. Worked as an assistant manager at the Fez restaurant for the next two years, where I supervised production methods and techniques to ensure quality and service standards, as well as customer satisfaction. I started working as an estate agent at Leverage Investment company in 2022. I was looking for something more than just an agency, then I met with Khaled and our team, who showed me bigger possibilities in this field.



# How do we work?



FAST RESPONSE



CREATIVE IDEAS



DEVELOPMENT

# What do we provide?



- INSPECTION TRIP
- ACCOMMODATION
- SOLE PROJECTS
- CONSULTING
- PARTNERSHIP
- AFFILIATE SYSTEM



**Inspection trip  
Accommodation**

**Exploring  
with the  
investors.**

**Let them see the  
moment in one of the  
best accommodation**

# Consulting

We have got 90% of successful  
consulted for our investors in 2022



90%

# Sole Projects

we have sold 85% of our sole  
projects in North Cyprus



85%

# Partnership

we can do

**1-3 SALES**

**15%**

**4 TO 5 SALES**

**17%**

**MORE THAN 5 SALES**

**20%**

Those are the total commission fees that we share 50% / 50%.  
Not all projects have the same commission we mention in the contract.

# Affiliate System

## More contracts more profits

### Representing us

Our partners can use the power to represent us and give the same features that we give to make partnership

### Education and Training

We provide education and training online and face to face about all that the partners can improve their skills

### Commission rates

The commission rates can be increased stage by stage up to 2.2% from the sales price of the affiliate sales

# Why us?



Transparency



Auditing



Right market price

# Our partners

"I've been working with Khaled since 2021 that I arranged some of Sub-Partners meetings with Khaled and we are still achieving new goals. "

SINIŠA  
FARKAŠ

Owner of Victory Real Estate Jdoo

"As a german businessman I always look for healthy work system and with Next Island's team everything goes clear and open. "

KIM  
SCHMIDT

Owner of KMS immo GmbH

"I didn't know how to sell to my Russians clients since I met Mariyam and I started to advertise to all russian speaker countries. "

INON  
ROMAN

Individual Partner and/or  
freelance

**Work  
with Us**



Sonersen Plaza, Girne  
Çevreyolu, Karaman 9935,  
North Cyprus, Kyrenia



[khaled.belfas@cyprusestates.net](mailto:khaled.belfas@cyprusestates.net)



[cyprusestates.net](http://cyprusestates.net)



+90 548 812 21 21

Khaled

16. 08. 2022.

20. 08. 2022.

Bro 12:36

How are you? 12:36

Where have you been? 12:36

I am dead here 12:36

Propušteni poziv 14:34

Jučer

Hello Siniša, I hope you are ok 20:33

I didn't hear anything from you since you left from here 20:33

I hope everything is fine 20:33

Because i don't know what's going on with you there 20:34

There is a lot of things happening here 20:34

So i think you need to know

Upiši poruku...



TOTAL REFERRING INCOME ②  
1.179,07 / 0,00 EUR  
NSM / 0,00 SLC

1179,07 (14,97%)  
prodians30@gmail.com

TOTAL AFFILIATE INCOME ②  
0,00 / 0,00 EUR  
0,00 / 0,00 SLC

sonsa.dajarak@gmail.com  
findes.sasa@gmail.com

MY INCOME FOR SELECTED BRANCH ②  
1.179,07 / 0,00 EUR  
NSM / 0,00 SLC

emil.zhuier@gmail.com  
@medredhina1@gmail.com

DIRECT AFFILIATE INCOME ②  
0,00 / 0,00 EUR  
0,00 / 0,00 SLC

suzanna.zorn1@gmail.com  
onyadajarak@gmail.com (Direct)

MY DIRECT AFFILIATE INCOME ②  
0,00 / 0,00 EUR  
0,00 / 0,00 SLC



nestoyavillas

Gesponsert

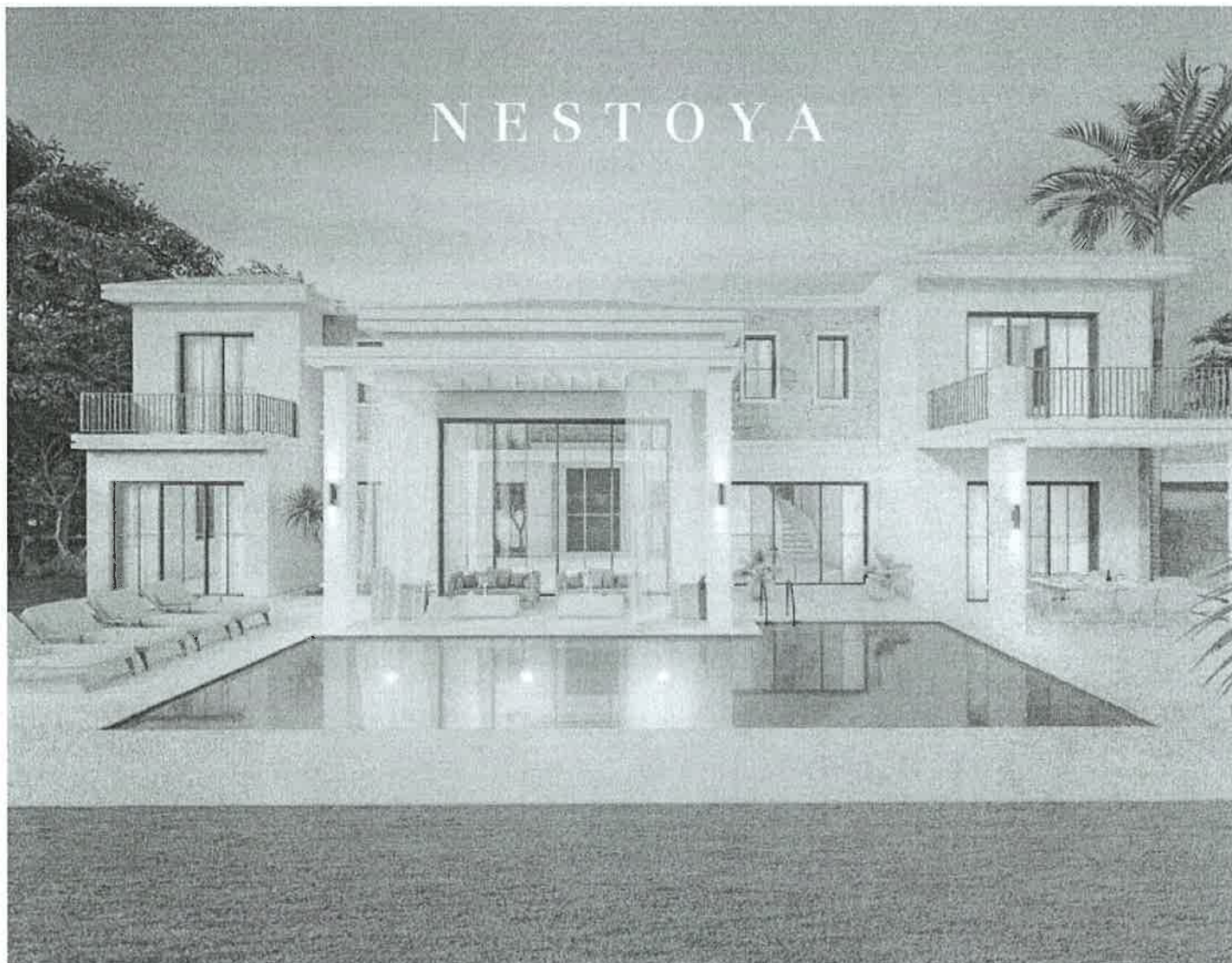

## 7 LUXURY VILLAS IN NORTH CYPRUS

STARTING FROM €850,000

Weitere Infos



← **Jani**  
Active 16 minutes ago

📞 📷 📱 📌

£ 239,564.10 | ₪ 71,975.80

You replied to Jani

I just need to know if he has now 350K

I don't think so, if he is planning to open a company here in North Cyprus

You replied to yourself

Item	Price	Commission	Total
Item 1	1000	100	1100
Item 2	2000	200	2200
Item 3	3000	300	3300
Item 4	4000	400	4400
Item 5	5000	500	5500
Item 6	6000	600	6600
Item 7	7000	700	7700
Item 8	8000	800	8800
Item 9	9000	900	9900
Item 10	10000	1000	11000

See the difference between the prices

+ commission

Or is commission what you should receive

Everything

The commission is already included in the prices without adding

I gave him money in July for quencia

↓  
Than all the suits were sold out

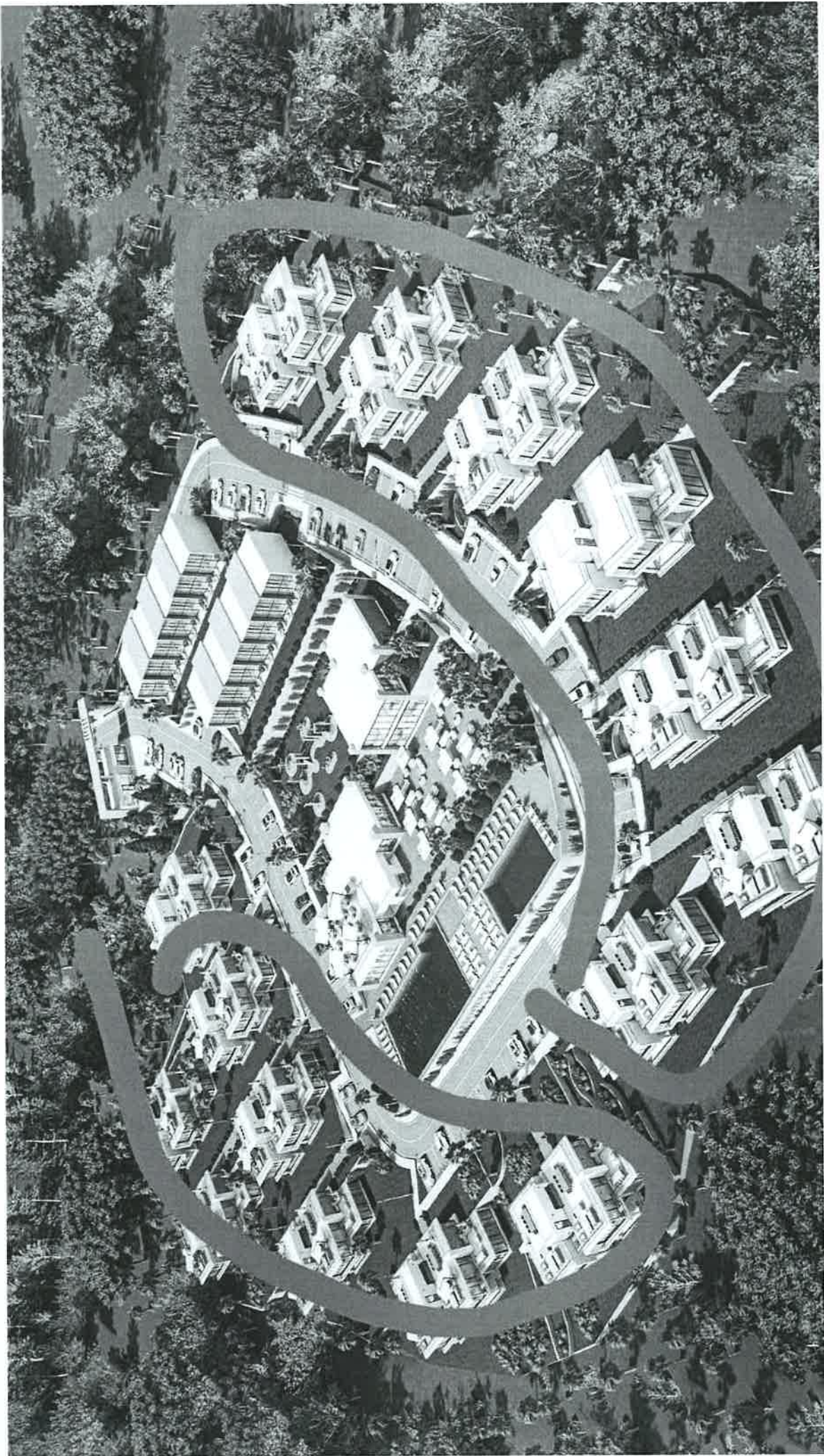

**CYPRIOI QUARTET TRAVEL LTD.**  
100, 102, 104, 106, 108, 110, 112, 114, 116, 118, 120, 122, 124, 126, 128, 130, 132, 134, 136, 138, 140, 142, 144, 146, 148, 150, 152, 154, 156, 158, 160, 162, 164, 166, 168, 170, 172, 174, 176, 178, 180, 182, 184, 186, 188, 190, 192, 194, 196, 198, 200, 202, 204, 206, 208, 210, 212, 214, 216, 218, 220, 222, 224, 226, 228, 230, 232, 234, 236, 238, 240, 242, 244, 246, 248, 250, 252, 254, 256, 258, 260, 262, 264, 266, 268, 270, 272, 274, 276, 278, 280, 282, 284, 286, 288, 290, 292, 294, 296, 298, 300, 302, 304, 306, 308, 310, 312, 314, 316, 318, 320, 322, 324, 326, 328, 330, 332, 334, 336, 338, 340, 342, 344, 346, 348, 350, 352, 354, 356, 358, 360, 362, 364, 366, 368, 370, 372, 374, 376, 378, 380, 382, 384, 386, 388, 390, 392, 394, 396, 398, 400, 402, 404, 406, 408, 410, 412, 414, 416, 418, 420, 422, 424, 426, 428, 430, 432, 434, 436, 438, 440, 442, 444, 446, 448, 450, 452, 454, 456, 458, 460, 462, 464, 466, 468, 470, 472, 474, 476, 478, 480, 482, 484, 486, 488, 490, 492, 494, 496, 498, 500, 502, 504, 506, 508, 510, 512, 514, 516, 518, 520, 522, 524, 526, 528, 530, 532, 534, 536, 538, 540, 542, 544, 546, 548, 550, 552, 554, 556, 558, 560, 562, 564, 566, 568, 570, 572, 574, 576, 578, 580, 582, 584, 586, 588, 590, 592, 594, 596, 598, 600, 602, 604, 606, 608, 610, 612, 614, 616, 618, 620, 622, 624, 626, 628, 630, 632, 634, 636, 638, 640, 642, 644, 646, 648, 650, 652, 654, 656, 658, 660, 662, 664, 666, 668, 670, 672, 674, 676, 678, 680, 682, 684, 686, 688, 690, 692, 694, 696, 698, 700, 702, 704, 706, 708, 710, 712, 714, 716, 718, 720, 722, 724, 726, 728, 730, 732, 734, 736, 738, 740, 742, 744, 746, 748, 750, 752, 754, 756, 758, 760, 762, 764, 766, 768, 770, 772, 774, 776, 778, 780, 782, 784, 786, 788, 790, 792, 794, 796, 798, 800, 802, 804, 806, 808, 810, 812, 814, 816, 818, 820, 822, 824, 826, 828, 830, 832, 834, 836, 838, 840, 842, 844, 846, 848, 850, 852, 854, 856, 858, 860, 862, 864, 866, 868, 870, 872, 874, 876, 878, 880, 882, 884, 886, 888, 890, 892, 894, 896, 898, 900, 902, 904, 906, 908, 910, 912, 914, 916, 918, 920, 922, 924, 926, 928, 930, 932, 934, 936, 938, 940, 942, 944, 946, 948, 950, 952, 954, 956, 958, 960, 962, 964, 966, 968, 970, 972, 974, 976, 978, 980, 982, 984, 986, 988, 990, 992, 994, 996, 998, 1000



A 02103

**MASTER  
MANAGEMENT  
GROUP**  
100, 102, 104, 106, 108, 110, 112, 114, 116, 118, 120, 122, 124, 126, 128, 130, 132, 134, 136, 138, 140, 142, 144, 146, 148, 150, 152, 154, 156, 158, 160, 162, 164, 166, 168, 170, 172, 174, 176, 178, 180, 182, 184, 186, 188, 190, 192, 194, 196, 198, 200, 202, 204, 206, 208, 210, 212, 214, 216, 218, 220, 222, 224, 226, 228, 230, 232, 234, 236, 238, 240, 242, 244, 246, 248, 250, 252, 254, 256, 258, 260, 262, 264, 266, 268, 270, 272, 274, 276, 278, 280, 282, 284, 286, 288, 290, 292, 294, 296, 298, 300, 302, 304, 306, 308, 310, 312, 314, 316, 318, 320, 322, 324, 326, 328, 330, 332, 334, 336, 338, 340, 342, 344, 346, 348, 350, 352, 354, 356, 358, 360, 362, 364, 366, 368, 370, 372, 374, 376, 378, 380, 382, 384, 386, 388, 390, 392, 394, 396, 398, 400, 402, 404, 406, 408, 410, 412, 414, 416, 418, 420, 422, 424, 426, 428, 430, 432, 434, 436, 438, 440, 442, 444, 446, 448, 450, 452, 454, 456, 458, 460, 462, 464, 466, 468, 470, 472, 474, 476, 478, 480, 482, 484, 486, 488, 490, 492, 494, 496, 498, 500, 502, 504, 506, 508, 510, 512, 514, 516, 518, 520, 522, 524, 526, 528, 530, 532, 534, 536, 538, 540, 542, 544, 546, 548, 550, 552, 554, 556, 558, 560, 562, 564, 566, 568, 570, 572, 574, 576, 578, 580, 582, 584, 586, 588, 590, 592, 594, 596, 598, 600, 602, 604, 606, 608, 610, 612, 614, 616, 618, 620, 622, 624, 626, 628, 630, 632, 634, 636, 638, 640, 642, 644, 646, 648, 650, 652, 654, 656, 658, 660, 662, 664, 666, 668, 670, 672, 674, 676, 678, 680, 682, 684, 686, 688, 690, 692, 694, 696, 698, 700, 702, 704, 706, 708, 710, 712, 714, 716, 718, 720, 722, 724, 726, 728, 730, 732, 734, 736, 738, 740, 742, 744, 746, 748, 750, 752, 754, 756, 758, 760, 762, 764, 766, 768, 770, 772, 774, 776, 778, 780, 782, 784, 786, 788, 790, 792, 794, 796, 798, 800, 802, 804, 806, 808, 810, 812, 814, 816, 818, 820, 822, 824, 826, 828, 830, 832, 834, 836, 838, 840, 842, 844, 846, 848, 850, 852, 854, 856, 858, 860, 862, 864, 866, 868, 870, 872, 874, 876, 878, 880, 882, 884, 886, 888, 890, 892, 894, 896, 898, 900, 902, 904, 906, 908, 910, 912, 914, 916, 918, 920, 922, 924, 926, 928, 930, 932, 934, 936, 938, 940, 942, 944, 946, 948, 950, 952, 954, 956, 958, 960, 962, 964, 966, 968, 970, 972, 974, 976, 978, 980, 982, 984, 986, 988, 990, 992, 994, 996, 998, 1000

**MASTER**  
Cyprus  
**GLOBAL**

**NEO CENTURY EHLAK LTD.**  
MANT SOKAK NO:28-C  
KARAKUM - GİRNE  
MS: 20428

Fatura Numu: 10.11.2022

FATURA / INVOICE

TRANSFER BEDELİ

€ 8.980,00

MATRAH € 8.980,00  
KDV % 5 Dahi  
TOPLAM € 8.980,00

Yalnız : Sekizbin dokuz yüzseksenEURO

**GARANTI BANKASI**  
ŞUBE: 1285- K.K.T.C.

TL	TR02 0006 3001 2800 0006 3071
USD	TR04 0006 3001 2800 0009 9992
EUR	TR19 0006 3001 2800 0001 0017
GBP	TR62 0006 3001 2800 0009 9992

Khaled

Do you have the offer also for 1st purchase, or the contract? Now talked to Aleksander, this afternoon we have conference call with Emil, Sinisa and some people from the company...

If they said ok

I will make the contract

So the construction will start in the middle of 2023 so he will earn more than 40% capital gains

So if the price today is £1.2m at that time the price will go up to £1.68m so the Sinisa will give us our 10% then he can take whatever he wants 15% or he can take the capital gains. So our commission is 10% from any price he sells

Ok... no problem, let you know all after the meeting...

Must be £1.2m or upper

Upiši poruku...





7:23 PM



 **Jani**  
Active Now



It's new challenge

 Hope you are well

Everything is great

Waiting for you here in North Cyprus

 You replied to Jani

Hope you are well

Thank you for asking

I was 2x since november

Sold 10 units

I have 5 more

 You replied to Jani

Sold 10 units

10 units? Where

But will sell them in feb or march

 )exclusive

This is great



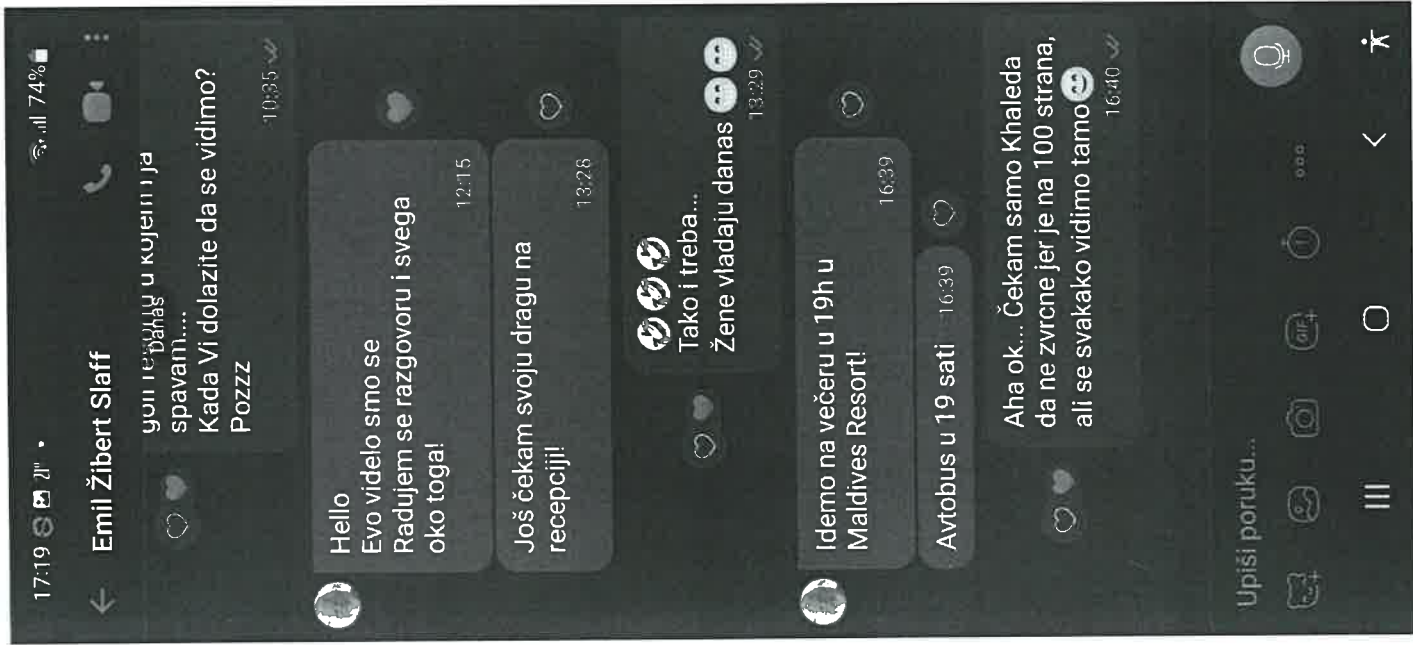

**Cyprus Constructions je na lokaciji Maldives Homes. • Prati**

Prije 1 h · Kyrenia, Kyrenia, Cyprus ·

**Executive Changes in Cyprus Constructions:**  
We would like to announce that Mustafa Tezel has replaced Ali Güler as our company's new CEO. The Cyprus Constructions family would like to wish Mustafa Tezel all the success in his new post.



18

Komentara: 7

Svida mi se

Komentirai

Podijeli



9:13 PM



Jani

Active 10 minutes ago



I know she gave him 35%

No, he told me that she has a problem with payment she can't pay more than 15%

And in the presentation was said 3 months of down-payment

Which is a lie we don't have 3 months of payment at all

But after he said she can't pay because of the banks

We said ok we can help her

This is not clean business what he has done

It is just mess of boys



Crazy



Aa



Khaled

He paid the first <sup>Danas</sup> payment 10:34

On time 10:34

0:08

Sender  
SL ENTERPRISES EOOD

Recipient  
MSN PROPERTY LTD •  
RESERVATION AGREEMENT

Amount  
€50,000

Sent on  
Tue, 16 Aug 2022, 06:34

Expected by  
Tue, 16 Aug 2022

**Want to send and receive money without hidden fees?**

Sign up to Revolut Business and  
avoid hidden fees and rubbish

Dont worry we will resolve all today 😊

10:37 ✓✓

Great 10:37

They are launching the project today at 19:00

10:37

Upiši poruku...



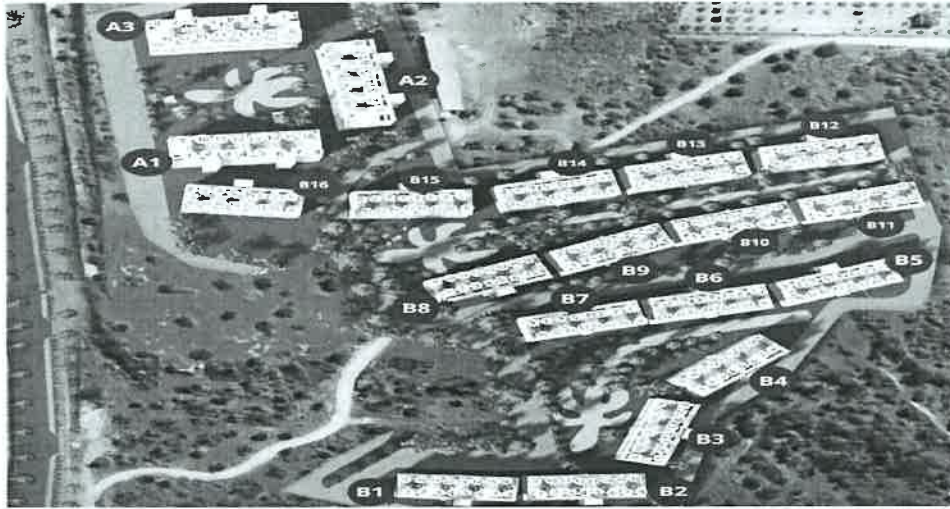

TYPE A1	APARTMENT TYPE	FLOOR	GROSS AREA m <sup>2</sup>	TERRACES m <sup>2</sup>		ROOF TERRACE m <sup>2</sup>	Total usage area m <sup>2</sup>	GBP PER M2	CURRENT PRICE (£)	STATUS
A1-1	1+1	GARDEN	50	10		-	60	£2,000	£120,000	AVAILABLE
A1-2	1+1	GARDEN	50	10		-	60	£2,000	£120,000	AVAILABLE
A1-3	1+1	GARDEN	50	10		-	60	£2,000	£120,000	AVAILABLE
A1-4	1+1	GARDEN	50	10		-	60	£2,000	£120,000	AVAILABLE
A1-5	1+1	GARDEN	50	10		-	60	£2,000	£120,000	AVAILABLE
A1-6	1+1	GARDEN	50	10		-	60	£2,000	£120,000	AVAILABLE
A1-7	1+1	GARDEN	50	10		-	60	£2,000	£120,000	AVAILABLE
A1-8	1+1	GARDEN	50	10		-	60	£2,000	£120,000	AVAILABLE
A1-9	2+1 LOFT	PENTHOUSE	75	10		50	135	£1,333	£180,000	AVAILABLE
A1-10	2+1 LOFT	PENTHOUSE	75	10		50	135	£1,333	£180,000	AVAILABLE
A1-11	2+1 LOFT	PENTHOUSE	75	10		50	135	£1,333	£180,000	AVAILABLE
A1-12	2+1 LOFT	PENTHOUSE	75	10		50	135	£1,333	£180,000	AVAILABLE
A1-13	2+1 LOFT	PENTHOUSE	75	10		50	135	£1,333	£180,000	AVAILABLE
A1-14	2+1 LOFT	PENTHOUSE	75	10		50	135	£1,333	£180,000	AVAILABLE
A1-15	2+1 LOFT	PENTHOUSE	75	10		50	135	£1,333	£180,000	AVAILABLE
A1-16	2+1 LOFT	PENTHOUSE	75	10		50	135	£1,333	£180,000	AVAILABLE

TYPE A2	APARTMENT TYPE	FLOOR	GROSS AREA m <sup>2</sup>	TERRACES m <sup>2</sup>		ROOF TERRACE m <sup>2</sup>	Total usage area m <sup>2</sup>	GBP PER M2	CURRENT PRICE (£)	STATUS
A2-1	1+1	GARDEN	50	10		-	60	£2,085	£125,000	AVAILABLE
A2-2	1+1	GARDEN	50	10		-	60	£2,085	£125,000	AVAILABLE
A2-3	1+1	GARDEN	50	10		-	60	£2,085	£125,000	AVAILABLE
A2-4	1+1	GARDEN	50	10		-	60	£2,085	£125,000	AVAILABLE
A2-5	1+1	GARDEN	50	10		-	60	£2,085	£125,000	AVAILABLE
A2-6	1+1	GARDEN	50	10		-	60	£2,085	£125,000	AVAILABLE
A2-7	1+1	GARDEN	50	10		-	60	£2,085	£125,000	AVAILABLE
A2-8	1+1	GARDEN	50	10		-	60	£2,085	£125,000	AVAILABLE
A2-9	2+1 LOFT	PENTHOUSE	75	10		50	135	£1,370	£185,000	AVAILABLE
A2-10	2+1 LOFT	PENTHOUSE	75	10		50	135	£1,370	£185,000	AVAILABLE
A2-11	2+1 LOFT	PENTHOUSE	75	10		50	135	£1,370	£185,000	AVAILABLE

A2-12	2+1 LOFT	PENTHOUSE	75	10		50	135	£1,370	£185,000	AVAILABLE
A2-13	2+1 LOFT	PENTHOUSE	75	10		50	135	£1,370	£185,000	AVAILABLE
A2-14	2+1 LOFT	PENTHOUSE	75	10		50	135	£1,370	£185,000	AVAILABLE
A2-15	2+1 LOFT	PENTHOUSE	75	10		50	135	£1,370	£185,000	AVAILABLE
A2-16	2+1 LOFT	PENTHOUSE	75	10		50	135	£1,370	£185,000	AVAILABLE

TYPE A3	APARTMENT TYPE	FLOOR	GROSS AREA m <sup>2</sup>	TERRACES m <sup>2</sup>		ROOF TERRACE m <sup>2</sup>	Total usage area m2	GBP PER M2	CURRENT PRICE (£)	STATUS
A3-1	1+1	GARDEN	50	10		-	60	£2,000	£120,000	AVAILABLE
A3-2	1+1	GARDEN	50	10		-	60	£2,000	£120,000	AVAILABLE
A3-3	1+1	GARDEN	50	10		-	60	£2,000	£120,000	AVAILABLE
A3-4	1+1	GARDEN	50	10		-	60	£2,000	£120,000	AVAILABLE
A3-5	1+1	GARDEN	50	10		-	60	£2,000	£120,000	AVAILABLE
A3-6	1+1	GARDEN	50	10		-	60	£2,000	£120,000	AVAILABLE
A3-7	1+1	GARDEN	50	10		-	60	£2,000	£120,000	AVAILABLE
A3-8	1+1	GARDEN	50	10		-	60	£2,000	£120,000	AVAILABLE
A3-9	2+1 LOFT	PENTHOUSE	75	10		50	135	£1,333	£180,000	AVAILABLE
A3-10	2+1 LOFT	PENTHOUSE	75	10		50	135	£1,333	£180,000	AVAILABLE
A3-11	2+1 LOFT	PENTHOUSE	75	10		50	135	£1,333	£180,000	AVAILABLE
A3-12	2+1 LOFT	PENTHOUSE	75	10		50	135	£1,333	£180,000	AVAILABLE
A3-13	2+1 LOFT	PENTHOUSE	75	10		50	135	£1,333	£180,000	AVAILABLE
A3-14	2+1 LOFT	PENTHOUSE	75	10		50	135	£1,333	£180,000	AVAILABLE
A3-15	2+1 LOFT	PENTHOUSE	75	10		50	135	£1,333	£180,000	AVAILABLE
A3-16	2+1 LOFT	PENTHOUSE	75	10		50	135	£1,333	£180,000	AVAILABLE

TYPE B1	APARTMENT TYPE	FLOOR	GROSS AREA m2	TERRACES m2		ROOF TERRACE m <sup>2</sup>	Total usage area m2	GBP PER M2	CURRENT PRICE £	STATUS
1 B1-1	STUDIO	GARDEN	35	8		-	43	£1,976	£85,000	AVAILABLE
1 B1-2	STUDIO	GARDEN	35	8		-	43	£1,976	£85,000	AVAILABLE
1 B1-3	STUDIO	GARDEN	35	8		-	43	£1,976	£85,000	AVAILABLE
1 B1-4	STUDIO	GARDEN	35	8		-	43	£1,976	£85,000	AVAILABLE
1 B1-5	STUDIO	GARDEN	35	8		-	43	£1,976	£85,000	AVAILABLE
1 B1-6	STUDIO	GARDEN	35	8		-	43	£1,976	£85,000	AVAILABLE
1 B1-7	STUDIO	GARDEN	35	8		-	43	£1,976	£85,000	AVAILABLE
1 B1-8	STUDIO	GARDEN	35	8		-	43	£1,976	£85,000	AVAILABLE
1 B1-9	STUDIO	PENTHOUSE	35	8		35	78	£1,217	£95,000	AVAILABLE
1 B1-10	STUDIO	PENTHOUSE	35	8		35	78	£1,217	£95,000	AVAILABLE
1 B1-11	STUDIO	PENTHOUSE	35	8		35	78	£1,217	£95,000	AVAILABLE
1 B1-12	STUDIO	PENTHOUSE	35	8		35	78	£1,217	£95,000	AVAILABLE
1 B1-13	STUDIO	PENTHOUSE	35	8		35	78	£1,217	£95,000	AVAILABLE
1 B1-14	STUDIO	PENTHOUSE	35	8		35	78	£1,217	£95,000	AVAILABLE
1 B1-15	STUDIO	PENTHOUSE	35	8		35	78	£1,217	£95,000	AVAILABLE
1 B1-16	STUDIO	PENTHOUSE	35	8		35	78	£1,217	£95,000	AVAILABLE

TYPE B2	APARTMENT TYPE	FLOOR	GROSS AREA m <sup>2</sup>	TERRACES m <sup>2</sup>		ROOF TERRACE m <sup>2</sup>	Total usage area m2	GBP PER M2	CURRENT PRICE (£)	STATUS
1 B2-1	STUDIO	GARDEN	35	8		-	43	£1,860	£80,000	AVAILABLE
1 B2-2	STUDIO	GARDEN	35	8		-	43	£1,860	£80,000	AVAILABLE
1 B2-3	STUDIO	GARDEN	35	8		-	43	£1,860	£80,000	AVAILABLE
1 B2-4	STUDIO	GARDEN	35	8		-	43	£1,860	£80,000	AVAILABLE
1 B2-5	STUDIO	GARDEN	35	8		-	43	£1,860	£80,000	AVAILABLE
1 B2-6	STUDIO	GARDEN	35	8		-	43	£1,860	£80,000	AVAILABLE
1 B2-7	STUDIO	GARDEN	35	8		-	43	£1,860	£80,000	AVAILABLE
1 B2-8	STUDIO	GARDEN	35	8		-	43	£1,860	£80,000	AVAILABLE

1	B2-9	STUDIO	PENTHOUSE	35	8		35	78	£1,153	£90,000	AVAILABLE
1	B2-10	STUDIO	PENTHOUSE	35	8		35	78	£1,153	£90,000	AVAILABLE
1	B2-11	STUDIO	PENTHOUSE	35	8		35	78	£1,153	£90,000	AVAILABLE
1	B2-12	STUDIO	PENTHOUSE	35	8		35	78	£1,153	£90,000	AVAILABLE
1	B2-13	STUDIO	PENTHOUSE	35	8		35	78	£1,153	£90,000	AVAILABLE
1	B2-14	STUDIO	PENTHOUSE	35	8		35	78	£1,153	£90,000	AVAILABLE
1	B2-15	STUDIO	PENTHOUSE	35	8		35	78	£1,153	£90,000	AVAILABLE
1	B2-16	STUDIO	PENTHOUSE	35	8		35	78	£1,153	£90,000	AVAILABLE

	TYPE B3	APARTMENT TYPE	FLOOR	GROSS AREA m <sup>2</sup>	TERRACES m <sup>2</sup>		ROOF TERRACE m <sup>2</sup>	Total usage area m2	GBP PER M2	CURRENT PRICE (£)	STATUS
1	B3-1	STUDIO	GARDEN	35	8		-	43	£1,976	£85,000	AVAILABLE
1	B3-2	STUDIO	GARDEN	35	8		-	43	£1,976	£85,000	AVAILABLE
1	B3-3	STUDIO	GARDEN	35	8		-	43	£1,976	£85,000	AVAILABLE
1	B3-4	STUDIO	GARDEN	35	8		-	43	£1,976	£85,000	AVAILABLE
1	B3-5	STUDIO	GARDEN	35	8		-	43	£1,976	£85,000	AVAILABLE
1	B3-6	STUDIO	GARDEN	35	8		-	43	£1,976	£85,000	AVAILABLE
1	B3-7	STUDIO	GARDEN	35	8		-	43	£1,976	£85,000	AVAILABLE
1	B3-8	STUDIO	GARDEN	35	8		-	43	£1,976	£85,000	AVAILABLE
1	B3-10	STUDIO	PENTHOUSE	35	8		35	78	£1,217	£95,000	AVAILABLE
1	B3-11	STUDIO	PENTHOUSE	35	8		35	78	£1,217	£95,000	AVAILABLE
1	B3-12	STUDIO	PENTHOUSE	35	8		35	78	£1,217	£95,000	AVAILABLE
1	B3-13	STUDIO	PENTHOUSE	35	8		35	78	£1,217	£95,000	AVAILABLE
1	B3-14	STUDIO	PENTHOUSE	35	8		35	78	£1,217	£95,000	AVAILABLE
1	B3-15	STUDIO	PENTHOUSE	35	8		35	78	£1,217	£95,000	AVAILABLE

	TYPE B4	APARTMENT TYPE	FLOOR	GROSS AREA m <sup>2</sup>	TERRACES m <sup>2</sup>		ROOF TERRACE m <sup>2</sup>	Total usage area m2	GBP PER M2	CURRENT PRICE (£)	STATUS
1	B4-1	STUDIO	GARDEN	35	8		-	43	£1,976	£85,000	AVAILABLE
1	B4-2	STUDIO	GARDEN	35	8		-	43	£1,976	£85,000	AVAILABLE
1	B4-3	STUDIO	GARDEN	35	8		-	43	£1,976	£85,000	AVAILABLE
1	B4-4	STUDIO	GARDEN	35	8		-	43	£1,976	£85,000	AVAILABLE
1	B4-5	STUDIO	GARDEN	35	8		-	43	£1,976	£85,000	AVAILABLE
1	B4-6	STUDIO	GARDEN	35	8		-	43	£1,976	£85,000	AVAILABLE
1	B4-7	STUDIO	GARDEN	35	8		-	43	£1,976	£85,000	AVAILABLE
1	B4-8	STUDIO	GARDEN	35	8		-	43	£1,976	£85,000	AVAILABLE
1	B4-9	STUDIO	PENTHOUSE	35	8		35	78	£1,217	£95,000	AVAILABLE
1	B4-10	STUDIO	PENTHOUSE	35	8		35	78	£1,217	£95,000	AVAILABLE
1	B4-11	STUDIO	PENTHOUSE	35	8		35	78	£1,217	£95,000	AVAILABLE
1	B4-12	STUDIO	PENTHOUSE	35	8		35	78	£1,217	£95,000	AVAILABLE
1	B4-13	STUDIO	PENTHOUSE	35	8		35	78	£1,217	£95,000	AVAILABLE
1	B4-14	STUDIO	PENTHOUSE	35	8		35	78	£1,217	£95,000	AVAILABLE
1	B4-15	STUDIO	PENTHOUSE	35	8		35	78	£1,217	£95,000	AVAILABLE
1	B4-16	STUDIO	PENTHOUSE	35	8		35	78	£1,217	£95,000	AVAILABLE

	TYPE B5	APARTMENT TYPE	FLOOR	GROSS AREA m <sup>2</sup>	TERRACES m <sup>2</sup>		ROOF TERRACE m <sup>2</sup>	Total usage area m2	GBP PER M2	CURRENT PRICE (£)	STATUS
1	B5-1	STUDIO	GARDEN	35	8		-	43	£1,627	£70,000	AVAILABLE
1	B5-2	STUDIO	GARDEN	35	8		-	43	£1,627	£70,000	AVAILABLE
1	B5-3	STUDIO	GARDEN	35	8		-	43	£1,627	£70,000	AVAILABLE
1	B5-4	STUDIO	GARDEN	35	8		-	43	£1,627	£70,000	AVAILABLE
1	B5-5	STUDIO	GARDEN	35	8		-	43	£1,627	£70,000	AVAILABLE
1	B5-6	STUDIO	GARDEN	35	8		-	43	£1,627	£70,000	AVAILABLE

1	B5-9	STUDIO	PENTHOUSE	35	8		35	78	£1,025	£80,000	AVAILABLE
1	B5-10	STUDIO	PENTHOUSE	35	8		35	78	£1,025	£80,000	AVAILABLE
1	B5-11	STUDIO	PENTHOUSE	35	8		35	78	£1,025	£80,000	AVAILABLE
1	B5-12	STUDIO	PENTHOUSE	35	8		35	78	£1,025	£80,000	AVAILABLE
1	B5-13	STUDIO	PENTHOUSE	35	8		35	78	£1,025	£80,000	AVAILABLE

TYPE B6	APARTMENT TYPE	FLOOR	GROSS AREA m <sup>2</sup>	TERRACES m <sup>2</sup>		ROOF TERRACE m <sup>2</sup>	Total usage area m2	GBP PER M2	CURRENT PRICE (£)	STATUS
1	B6-1	STUDIO	GARDEN	35	8	-	43	£1,860	£80,000	AVAILABLE
1	B6-2	STUDIO	GARDEN	35	8	-	43	£1,860	£80,000	AVAILABLE
1	B6-3	STUDIO	GARDEN	35	8	-	43	£1,860	£80,000	AVAILABLE
1	B6-4	STUDIO	GARDEN	35	8	-	43	£1,860	£80,000	AVAILABLE
1	B6-5	STUDIO	GARDEN	35	8	-	43	£1,860	£80,000	AVAILABLE
1	B6-6	STUDIO	GARDEN	35	8	-	43	£1,860	£80,000	AVAILABLE
1	B6-7	STUDIO	GARDEN	35	8	-	43	£1,860	£80,000	AVAILABLE
1	B6-8	STUDIO	GARDEN	35	8	-	43	£1,860	£80,000	AVAILABLE
1	B6-9	STUDIO	PENTHOUSE	35	8	35	78	£1,153	£90,000	AVAILABLE
1	B6-10	STUDIO	PENTHOUSE	35	8	35	78	£1,153	£90,000	AVAILABLE
1	B6-11	STUDIO	PENTHOUSE	35	8	35	78	£1,153	£90,000	AVAILABLE
1	B6-12	STUDIO	PENTHOUSE	35	8	35	78	£1,153	£90,000	AVAILABLE
1	B6-13	STUDIO	PENTHOUSE	35	8	35	78	£1,153	£90,000	AVAILABLE
1	B6-14	STUDIO	PENTHOUSE	35	8	35	78	£1,153	£90,000	AVAILABLE
1	B6-15	STUDIO	PENTHOUSE	35	8	35	78	£1,153	£90,000	AVAILABLE
1	B6-16	STUDIO	PENTHOUSE	35	8	35	78	£1,153	£90,000	AVAILABLE

TYPE B7	APARTMENT TYPE	FLOOR	GROSS AREA m <sup>2</sup>	TERRACES m <sup>2</sup>		ROOF TERRACE m <sup>2</sup>	Total usage area m2	GBP PER M2	CURRENT PRICE (£)	STATUS
1	B7-1	STUDIO	GARDEN	35	8	-	43	£1,976	£85,000	AVAILABLE
1	B7-2	STUDIO	GARDEN	35	8	-	43	£1,976	£85,000	AVAILABLE
1	B7-3	STUDIO	GARDEN	35	8	-	43	£1,976	£85,000	AVAILABLE
1	B7-4	STUDIO	GARDEN	35	8	-	43	£1,976	£85,000	AVAILABLE
1	B7-5	STUDIO	GARDEN	35	8	-	43	£1,976	£85,000	AVAILABLE
1	B7-6	STUDIO	GARDEN	35	8	-	43	£1,976	£85,000	AVAILABLE
1	B7-7	STUDIO	GARDEN	35	8	-	43	£1,976	£85,000	AVAILABLE
1	B7-8	STUDIO	GARDEN	35	8	-	43	£1,976	£85,000	AVAILABLE
1	B7-9	STUDIO	PENTHOUSE	35	8	35	78	£1,217	£95,000	AVAILABLE
1	B7-10	STUDIO	PENTHOUSE	35	8	35	78	£1,217	£95,000	AVAILABLE
1	B7-11	STUDIO	PENTHOUSE	35	8	35	78	£1,217	£95,000	AVAILABLE
1	B7-12	STUDIO	PENTHOUSE	35	8	35	78	£1,217	£95,000	AVAILABLE
1	B7-13	STUDIO	PENTHOUSE	35	8	35	78	£1,217	£95,000	AVAILABLE
1	B7-14	STUDIO	PENTHOUSE	35	8	35	78	£1,217	£95,000	AVAILABLE
1	B7-15	STUDIO	PENTHOUSE	35	8	35	78	£1,217	£95,000	AVAILABLE
1	B7-16	STUDIO	PENTHOUSE	35	8	35	78	£1,217	£95,000	AVAILABLE

TYPE B8	APARTMENT TYPE	FLOOR	GROSS AREA m <sup>2</sup>	TERRACES m <sup>2</sup>		ROOF TERRACE m <sup>2</sup>	Total usage area m2	GBP PER M2	CURRENT PRICE (£)	STATUS
1	B8-7	STUDIO	GARDEN	35	8	-	43	£1,976	£85,000	AVAILABLE
1	B8-8	STUDIO	GARDEN	35	8	-	43	£1,976	£85,000	AVAILABLE

TYPE B9	APARTMENT TYPE	FLOOR	GROSS AREA m <sup>2</sup>	TERRACES m <sup>2</sup>		ROOF TERRACE m <sup>2</sup>	Total usage area m2	GBP PER M2	CURRENT PRICE (£)	STATUS
B9-1	STUDIO	GARDEN	35	8		-	43	£1,860	£80,000	AVAILABLE
B9-2	STUDIO	GARDEN	35	8		-	43	£1,860	£80,000	AVAILABLE
B9-3	STUDIO	GARDEN	35	8		-	43	£1,860	£80,000	AVAILABLE
B9-4	STUDIO	GARDEN	35	8		-	43	£1,860	£80,000	AVAILABLE
B9-5	STUDIO	GARDEN	35	8		-	43	£1,860	£80,000	AVAILABLE
B9-6	STUDIO	GARDEN	35	8		-	43	£1,860	£80,000	AVAILABLE
B9-7	STUDIO	GARDEN	35	8		-	43	£1,860	£80,000	AVAILABLE
B9-8	STUDIO	GARDEN	35	8		-	43	£1,860	£80,000	AVAILABLE
B9-9	STUDIO	PENTHOUSE	35	8		35	78	£1,153	£90,000	AVAILABLE
B9-10	STUDIO	PENTHOUSE	35	8		35	78	£1,153	£90,000	AVAILABLE
B9-11	STUDIO	PENTHOUSE	35	8		35	78	£1,153	£90,000	AVAILABLE
B9-12	STUDIO	PENTHOUSE	35	8		35	78	£1,153	£90,000	AVAILABLE
B9-13	STUDIO	PENTHOUSE	35	8		35	78	£1,153	£90,000	AVAILABLE
B9-14	STUDIO	PENTHOUSE	35	8		35	78	£1,153	£90,000	AVAILABLE
B9-15	STUDIO	PENTHOUSE	35	8		35	78	£1,153	£90,000	AVAILABLE
B9-16	STUDIO	PENTHOUSE	35	8		35	78	£1,153	£90,000	AVAILABLE

TYPE B10	APARTMENT TYPE	FLOOR	GROSS AREA m <sup>2</sup>	TERRACES m <sup>2</sup>		ROOF TERRACE m <sup>2</sup>	Total usage area m2		CURRENT PRICE (£)	STATUS
B10-1	STUDIO	GARDEN	35	8		-	43	£1,744	£75,000	AVAILABLE
B10-2	STUDIO	GARDEN	35	8		-	43	£1,744	£75,000	AVAILABLE
B10-3	STUDIO	GARDEN	35	8		-	43	£1,744	£75,000	AVAILABLE
B10-4	STUDIO	GARDEN	35	8		-	43	£1,744	£75,000	AVAILABLE
B10-5	STUDIO	GARDEN	35	8		-	43	£1,744	£75,000	AVAILABLE
B10-6	STUDIO	GARDEN	35	8		-	43	£1,744	£75,000	AVAILABLE
B10-7	STUDIO	GARDEN	35	8		-	43	£1,744	£75,000	AVAILABLE
B10-8	STUDIO	GARDEN	35	8		-	43	£1,744	£75,000	AVAILABLE
B10-9	STUDIO	PENTHOUSE	35	8		35	78	£1,089	£85,000	AVAILABLE
B10-10	STUDIO	PENTHOUSE	35	8		35	78	£1,089	£85,000	AVAILABLE
B10-11	STUDIO	PENTHOUSE	35	8		35	78	£1,089	£85,000	AVAILABLE
B10-12	STUDIO	PENTHOUSE	35	8		35	78	£1,089	£85,000	AVAILABLE
B10-13	STUDIO	PENTHOUSE	35	8		35	78	£1,089	£85,000	AVAILABLE
B10-14	STUDIO	PENTHOUSE	35	8		35	78	£1,089	£85,000	AVAILABLE
B10-15	STUDIO	PENTHOUSE	35	8		35	78	£1,089	£85,000	AVAILABLE
B10-16	STUDIO	PENTHOUSE	35	8		35	78	£1,089	£85,000	AVAILABLE

TYPE B11	APARTMENT TYPE	FLOOR	GROSS AREA m <sup>2</sup>	TERRACES m <sup>2</sup>		ROOF TERRACE m <sup>2</sup>	Total usage area m2		CURRENT PRICE (£)	STATUS
B11-1	STUDIO	GARDEN	35	8		-	43	£1,744	£75,000	AVAILABLE
B11-2	STUDIO	GARDEN	35	8		-	43	£1,744	£75,000	AVAILABLE
B11-3	STUDIO	GARDEN	35	8		-	43	£1,744	£75,000	AVAILABLE
B11-4	STUDIO	GARDEN	35	8		-	43	£1,744	£75,000	AVAILABLE
B11-5	STUDIO	GARDEN	35	8		-	43	£1,744	£75,000	AVAILABLE
B11-6	STUDIO	GARDEN	35	8		-	43	£1,744	£75,000	AVAILABLE
B11-7	STUDIO	GARDEN	35	8		-	43	£1,744	£75,000	AVAILABLE
B11-8	STUDIO	GARDEN	35	8		-	43	£1,744	£75,000	AVAILABLE
B11-9	STUDIO	PENTHOUSE	35	8		35	78	£1,089	£85,000	AVAILABLE
B11-10	STUDIO	PENTHOUSE	35	8		35	78	£1,089	£85,000	AVAILABLE
B11-11	STUDIO	PENTHOUSE	35	8		35	78	£1,089	£85,000	AVAILABLE
B11-12	STUDIO	PENTHOUSE	35	8		35	78	£1,089	£85,000	AVAILABLE

1	B11-13	STUDIO	PENTHOUSE	35	8		35	78	£1,089	£85,000	AVAILABLE
1	B11-14	STUDIO	PENTHOUSE	35	8		35	78	£1,089	£85,000	AVAILABLE
1	B11-15	STUDIO	PENTHOUSE	35	8		35	78	£1,089	£85,000	AVAILABLE
1	B11-16	STUDIO	PENTHOUSE	35	8		35	78	£1,089	£85,000	AVAILABLE

TYPE B12	APARTMENT TYPE	FLOOR	GROSS AREA m <sup>2</sup>	TERRACES m <sup>2</sup>		ROOF TERRACE m <sup>2</sup>	Total usage area m2		CURRENT PRICE (£)	STATUS	
1	B12-1	STUDIO	GARDEN	35	8		-	43	£1,744	£75,000	AVAILABLE
1	B12-2	STUDIO	GARDEN	35	8		-	43	£1,744	£75,000	AVAILABLE
1	B12-3	STUDIO	GARDEN	35	8		-	43	£1,744	£75,000	AVAILABLE
1	B12-4	STUDIO	GARDEN	35	8		-	43	£1,744	£75,000	AVAILABLE
1	B12-5	STUDIO	GARDEN	35	8		-	43	£1,744	£75,000	AVAILABLE
1	B12-6	STUDIO	GARDEN	35	8		-	43	£1,744	£75,000	AVAILABLE
1	B12-7	STUDIO	GARDEN	35	8		-	43	£1,744	£75,000	AVAILABLE
1	B12-8	STUDIO	GARDEN	35	8		-	43	£1,744	£75,000	AVAILABLE
1	B12-9	STUDIO	PENTHOUSE	35	8		35	78	£1,089	£85,000	AVAILABLE
1	B12-10	STUDIO	PENTHOUSE	35	8		35	78	£1,089	£85,000	AVAILABLE
1	B12-11	STUDIO	PENTHOUSE	35	8		35	78	£1,089	£85,000	AVAILABLE
1	B12-12	STUDIO	PENTHOUSE	35	8		35	78	£1,089	£85,000	AVAILABLE
1	B12-13	STUDIO	PENTHOUSE	35	8		35	78	£1,089	£85,000	AVAILABLE
1	B12-14	STUDIO	PENTHOUSE	35	8		35	78	£1,089	£85,000	AVAILABLE
1	B12-15	STUDIO	PENTHOUSE	35	8		35	78	£1,089	£85,000	AVAILABLE
1	B12-16	STUDIO	PENTHOUSE	35	8		35	78	£1,089	£85,000	AVAILABLE

TYPE B13	APARTMENT TYPE	FLOOR	GROSS AREA m <sup>2</sup>	TERRACES m <sup>2</sup>		ROOF TERRACE m <sup>2</sup>	Total usage area m2		CURRENT PRICE (£)	STATUS	
1	B13-1	STUDIO	GARDEN	35	8		-	43	£1,744	£75,000	AVAILABLE
1	B13-2	STUDIO	GARDEN	35	8		-	43	£1,744	£75,000	AVAILABLE
1	B13-3	STUDIO	GARDEN	35	8		-	43	£1,744	£75,000	AVAILABLE
1	B13-4	STUDIO	GARDEN	35	8		-	43	£1,744	£75,000	AVAILABLE
1	B13-5	STUDIO	GARDEN	35	8		-	43	£1,744	£75,000	AVAILABLE
1	B13-6	STUDIO	GARDEN	35	8		-	43	£1,744	£75,000	AVAILABLE
1	B13-7	STUDIO	GARDEN	35	8		-	43	£1,744	£75,000	AVAILABLE
1	B13-8	STUDIO	GARDEN	35	8		-	43	£1,744	£75,000	AVAILABLE
1	B13-9	STUDIO	PENTHOUSE	35	8		35	78	£1,089	£85,000	AVAILABLE
1	B13-10	STUDIO	PENTHOUSE	35	8		35	78	£1,089	£85,000	AVAILABLE
1	B13-11	STUDIO	PENTHOUSE	35	8		35	78	£1,089	£85,000	AVAILABLE
1	B13-12	STUDIO	PENTHOUSE	35	8		35	78	£1,089	£85,000	AVAILABLE
1	B13-13	STUDIO	PENTHOUSE	35	8		35	78	£1,089	£85,000	AVAILABLE
1	B13-14	STUDIO	PENTHOUSE	35	8		35	78	£1,089	£85,000	AVAILABLE
1	B13-15	STUDIO	PENTHOUSE	35	8		35	78	£1,089	£85,000	AVAILABLE
1	B13-16	STUDIO	PENTHOUSE	35	8		35	78	£1,089	£85,000	AVAILABLE

TYPE B14	APARTMENT TYPE	FLOOR	GROSS AREA m <sup>2</sup>	TERRACES m <sup>2</sup>		ROOF TERRACE m <sup>2</sup>	Total usage area m2	GBP PER M2	CURRENT PRICE (£)	STATUS	
1	B14-1	STUDIO	GARDEN	35	8		-	43	£1,860	£80,000	AVAILABLE
1	B14-2	STUDIO	GARDEN	35	8		-	43	£1,860	£80,000	AVAILABLE
1	B14-3	STUDIO	GARDEN	35	8		-	43	£1,860	£80,000	AVAILABLE
1	B14-4	STUDIO	GARDEN	35	8		-	43	£1,860	£80,000	AVAILABLE
1	B14-5	STUDIO	GARDEN	35	8		-	43	£1,860	£80,000	AVAILABLE
1	B14-6	STUDIO	GARDEN	35	8		-	43	£1,860	£80,000	AVAILABLE
1	B14-7	STUDIO	GARDEN	35	8		-	43	£1,860	£80,000	AVAILABLE

1	B14-8	STUDIO	GARDEN	35	8		-	43	£1,860	£80,000	AVAILABLE
1	B14-9	STUDIO	PENTHOUSE	35	8		35	78	£1,153	£90,000	AVAILABLE
1	B14-10	STUDIO	PENTHOUSE	35	8		35	78	£1,153	£90,000	AVAILABLE
1	B14-11	STUDIO	PENTHOUSE	35	8		35	78	£1,153	£90,000	AVAILABLE
1	B14-12	STUDIO	PENTHOUSE	35	8		35	78	£1,153	£90,000	AVAILABLE
1	B14-13	STUDIO	PENTHOUSE	35	8		35	78	£1,153	£90,000	AVAILABLE
1	B14-14	STUDIO	PENTHOUSE	35	8		35	78	£1,153	£90,000	AVAILABLE
1	B14-15	STUDIO	PENTHOUSE	35	8		35	78	£1,153	£90,000	AVAILABLE
1	B14-16	STUDIO	PENTHOUSE	35	8		35	78	£1,153	£90,000	AVAILABLE

	TYPE B15	APARTMENT TYPE	FLOOR	GROSS AREA m <sup>2</sup>	TERRACES m <sup>2</sup>		ROOF TERRACE m <sup>2</sup>	Total usage area m <sup>2</sup>	GBP PER M2	CURRENT PRICE (£)	STATUS
1	B15-5	STUDIO	GARDEN	35	8		-	43	£1,976	£85,000	AVAILABLE
1	B15-6	STUDIO	GARDEN	35	8		-	43	£1,976	£85,000	AVAILABLE
1	B15-7	STUDIO	GARDEN	35	8		-	43	£1,976	£85,000	AVAILABLE
1	B15-8	STUDIO	GARDEN	35	8		-	43	£1,976	£85,000	AVAILABLE

	TYPE B16	APARTMENT TYPE	FLOOR	GROSS AREA m <sup>2</sup>	TERRACES m <sup>2</sup>		ROOF TERRACE m <sup>2</sup>	Total usage area m <sup>2</sup>	GBP PER M2	CURRENT PRICE (£)	STATUS
1	B16-1	STUDIO	GARDEN	35	8		-	43	£2,093	£90,000	AVAILABLE
1	B16-2	STUDIO	GARDEN	35	8		-	43	£2,093	£90,000	AVAILABLE
1	B16-3	STUDIO	GARDEN	35	8		-	43	£2,093	£90,000	AVAILABLE
1	B16-4	STUDIO	GARDEN	35	8		-	43	£2,093	£90,000	AVAILABLE
1	B16-5	STUDIO	GARDEN	35	8		-	43	£2,093	£90,000	AVAILABLE
1	B16-6	STUDIO	GARDEN	35	8		-	43	£2,093	£90,000	AVAILABLE
1	B16-7	STUDIO	GARDEN	35	8		-	43	£2,093	£90,000	AVAILABLE
1	B16-8	STUDIO	GARDEN	35	8		-	43	£2,093	£90,000	AVAILABLE
1	B16-9	STUDIO	PENTHOUSE	35	8		35	78	£1,282	£100,000	AVAILABLE
1	B16-10	STUDIO	PENTHOUSE	35	8		35	78	£1,282	£100,000	AVAILABLE
1	B16-11	STUDIO	PENTHOUSE	35	8		35	78	£1,282	£100,000	AVAILABLE
1	B16-12	STUDIO	PENTHOUSE	35	8		35	78	£1,282	£100,000	AVAILABLE
1	B16-13	STUDIO	PENTHOUSE	35	8		35	78	£1,282	£100,000	AVAILABLE
1	B16-14	STUDIO	PENTHOUSE	35	8		35	78	£1,282	£100,000	AVAILABLE
1	B16-15	STUDIO	PENTHOUSE	35	8		35	78	£1,282	£100,000	AVAILABLE
1	B16-16	STUDIO	PENTHOUSE	35	8		35	78	£1,282	£100,000	AVAILABLE



Jani

Active 16 minutes ago



If they were selling 30 units a month this is something new for me

I have never seen it



And you know the island

It's very small

We can know everything

It's a lie just

I have met with Sinisa 198 people and just 8 sales



If they were selling 30 units from any construction company you would probably know

You replied to Jani

If they were selling 30 units from any construction company you would probably know

Of course

I would know

But they are not doing shit

They are trying to sell Feentens



Aa



These 4 units I met the clients  
I know them  
He sold to them higher by 30%  
So in the future these people

Just 4  
You replied to yourself

Hehe great 

Not for units  
Just 4  
And 16 units we don't know  
about them anything

Did he pay 35% downpayment 

I dont understand now

£80,000 for deposit  
£185,000 approximately for  
down payment  
But this 185,000 for different  
people  
£265,000 but this money for  
another people

10:53 AM



+44 7909 272552



Block

Add

Today

🔒 Messages and calls are end-to-end encrypted. No one outside of this chat, not even WhatsApp, can read or listen to them. Tap to learn more.

Dear Sir Belfas I contact you behalf of Mr Farkas

10:15 AM

Nice to meet you my name is Christophe Lauwers

10:15 AM

I contact you because he told me you can help me With the Real investment and you have a also a crypto project right ?

10:15 AM

+44 7909 272552

Dear Sir Belfas I contact you behalf of Mr Farkas

Hello Mr. Christophe

10:50 AM ✓✓

+44 7909 272552

Nice to meet you my name is Christophe Lauwers

Nice to meet you too

10:50 AM ✓✓

+44 7909 272552

I contact you because he told me you can help me With the Real investment and you have a also a crypto project right ?

Yes, we do have some opportunities in



Message



6:04 PM

Signal strength, Wi-Fi, and 20% battery icons



Jani

Active Now



Hello

How are you?



Fine thanks you?

I am great

<< You replied to Jani

Sold 10 units

I was checking about this 10x

But there is nothing on the system about them

There are just 4 sales related to another people



Seriously?

Yes

They were sold directly from Sinisa...



Do you see that?

Sini ↓ not the owner of the project or the units



Aa



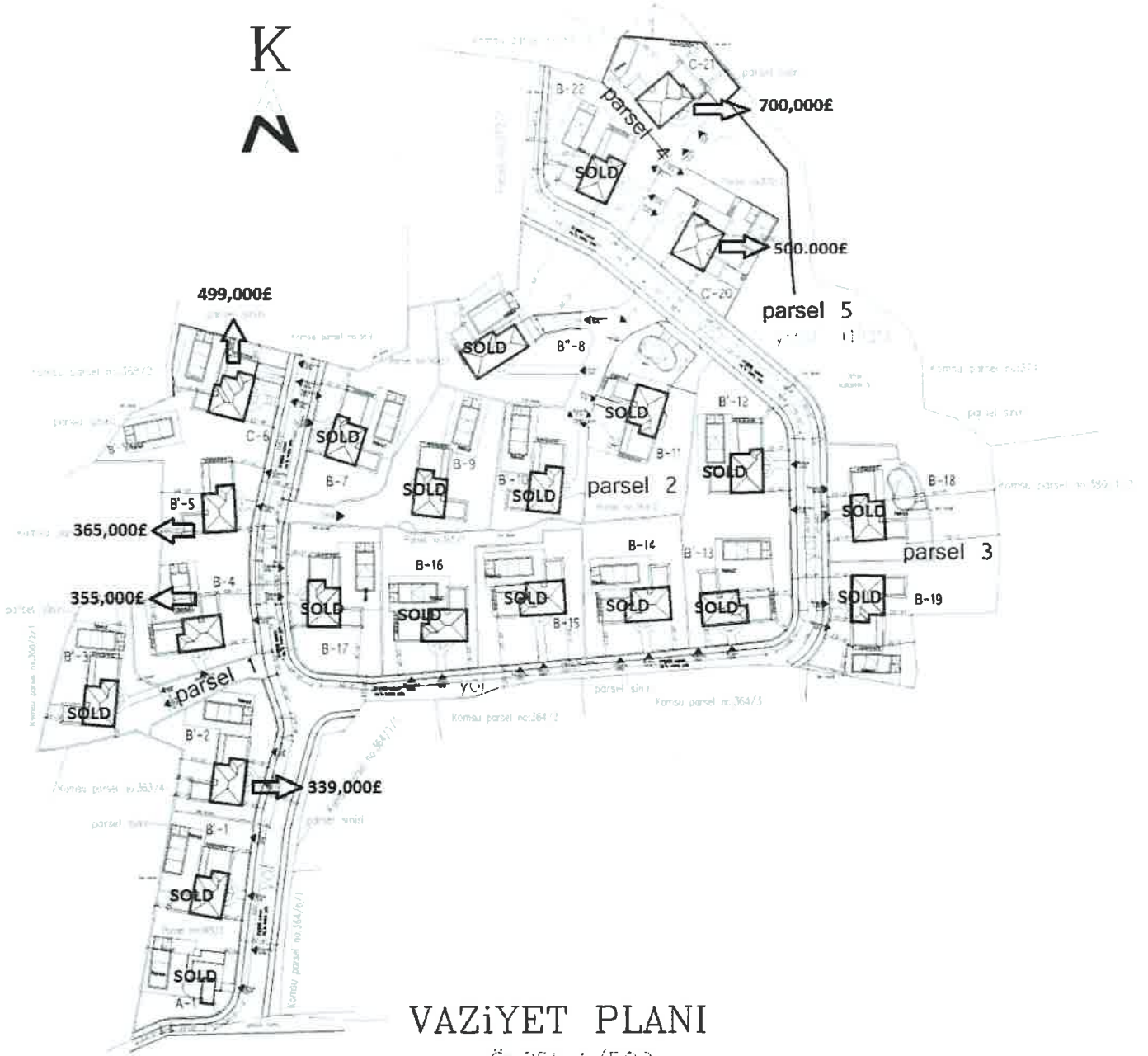

**VAZİYET PLANI**  
ÖLÇEK:1/500



e-mail shortly.

We are pleased that you have selected us for your stay. Included in this e-mail we have provided some useful information regarding your upcoming trip. Please don't hesitate to contact us with any changes.

<b>Hotel Name</b>	Maldive Holiday Homes
<b>Confirmation Number</b>	R531192177
<b>Call center agent</b>	Resat Dervis
<b>Guest Name</b>	Century 21- Kaan
<b>Check-in date</b>	Nov 21, 2022
<b>Check-out date</b>	Nov 24, 2022

<b>Room Type</b>	Garden Premium Suite
<b>Meal plan</b>	Room Only
<b>Guest Count</b>	2
<b>Room Total</b>	€ 240

<b>Cancellation</b>	Cancelations or changes made after 12:00 on 3 days before checkin date are subject to a Rate for one night penalty. No refunds for no shows or early checkouts.
---------------------	---

Reservation details



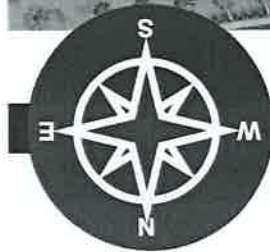

# BAHAMAS

HOMES

## AVAILABILITY MAP

AUG 27TH 6PM

**A BLOCKS** - ONE BEDROOM GARDEN APARTMENTS & TWO BEDROOM LOFT PENTHOUSE APARTMENTS

**B BLOCKS** - STUDIO GARDEN APARTMENTS & STUDIO PENTHOUSE APARTMENTS

#1 - #8 GARDEN APARTMENTS

#9 - #16 PENTHOUSE APARTMENTS

● AVAILABLE ● RESERVED



CYPRUSCONSTRUCTIONS

9:12 PM

Signal strength, Wi-Fi, and battery icons



Jani

Active 16 minutes ago



I can't say anything at the moment it's a surprise

WED AT 5:38 PM

Hello

How are you?



Fine thanks you?

I am great

You replied to Jani

Sold 10 units

I was checking about this 10x

But there is nothing on the system about them

There are just 4 sales related to another people



Seriously?

Yes

They were sold directly from Sinisa...



Do you see that?





**Dmitrij Chehovskoj**  
Active now



Infront of the sea



each product has its own buyer ;)

It can be

But each product has an amazing dealer behind 🐾

Thats true



I still wait the correct contract from Siniša



Because 25% it is too much (

We can sort it out



Between us ;)

He will contact me soon for new solution



Message...



#	No	Apartment	Type	Close Area m <sup>2</sup>
1	B1	Garden	Studio	42
2	B2	Garden	Studio	42
3	B3	Garden	Studio	42
4	B4	Garden	Studio	42
5	B5	First Floor	2 Bedroom Penthouse	96
6	B6	First Floor	2 Bedroom Penthouse	96
7	C1	Garden	Studio	42
8	C2	Garden	Studio	42
9	C3	Garden	Studio	42
10	C4	Garden	Studio	42
11	C5	First Floor	2 Bedroom Penthouse	96
12	C6	First Floor	2 Bedroom Penthouse	96
13	D1	Garden	Studio	42
14	D2	Garden	Studio	42
15	D3	Garden	Studio	42
16	D4	Garden	Studio	42
17	D5	First Floor	2 Bedroom Penthouse	96
18	D6	First Floor	2 Bedroom Penthouse	96
19	E1	Garden	Studio	42
20	E2	Garden	Studio	42
21	E3	Garden	Studio	42
22	E4	Garden	Studio	42
23	E5	First Floor	2 Bedroom Penthouse	96
24	E6	First Floor	2 Bedroom Penthouse	96
25	F1	Garden	Studio	42
26	F2	Garden	Studio	42
27	F3	Garden	Studio	42
28	F4	Garden	Studio	42
29	F5	First Floor	2 Bedroom Penthouse	96
30	F6	First Floor	2 Bedroom Penthouse	96
31	L1	Garden	Studio	42
32	L2	Garden	Studio	42
33	L3	Garden	Studio	42
34	L4	Garden	Studio	42
35	L5	First Floor	2 Bedroom Penthouse	96
36	L6	First Floor	2 Bedroom Penthouse	96
37	N1	Garden	Studio	42
38	N2	Garden	Studio	42
39	N3	Garden	Studio	42
40	N4	Garden	Studio	42
41	N5	First Floor	2 Bedroom Penthouse	96
42	N6	First Floor	2 Bedroom Penthouse	96
43	O1	Garden	Studio	42
44	O2	Garden	Studio	42
45	O3	Garden	Studio	42
46	O4	Garden	Studio	42
47	O5	First Floor	2 Bedroom Penthouse	96

48	O6	First Floor	2 Bedroom Penthouse	96
49	P1	Garden	Studio	42
50	P2	Garden	Studio	42
51	P3	Garden	Studio	42
52	P4	Garden	Studio	42
53	P5	First Floor	2 Bedroom Penthouse	96
54	P6	First Floor	2 Bedroom Penthouse	96
55	R1	Apt 1	2+1 Loft	75
56	R2	Apt 2	2+1 Loft	75
57	R3	Apt 3	2+1 Loft	75
58	R4	Apt 4	2+1 Loft	75
59	R5	Apt 5	2+1 Loft	75
60	R6	Apt 6	2+1 Loft	75
61	R7	Apt 7	2+1 Loft	75
62	S1	Apt 8	2+1 Loft	75
63	S2	Apt 9	2+1 Loft	75
64	S3	Apt 10	2+1 Loft	75
65	S4	Apt 11	2+1 Loft	75
66	S5	Apt 12	2+1 Loft	75
67	S6	Apt 13	2+1 Loft	75
68	S7	Apt 14	2+1 Loft	75
69	MV1	Villa 1	3+1	180
70	MV2	Villa 2	3+1	180
71	KV1	Villa 3	3+1	180
72	KV2	Villa 4	3+1	#ERROR!
73	JV1	Villa 5	3+1	180
74	JV2	Villa 6	3+1	180
75	IV1	Villa 7	3+1	180
76	IV2	Villa 8	3+1	180
77	HV1	Villa 9	3+1	180
78	HV2	Villa 10	3+1	180
79	GV1	Villa 11	3+1	180
80	GV2	Villa 12	3+1	180

Garden Terrace	Roof Terrace	Pool	Gross Area m <sup>2</sup>	1.Price Per M2	Launching Price
20		∞	62	£ 1.241,90	£ 76.997,80
20		∞	62	£ 1.160,90	£ 71.975,80
20		∞	62	£ 1.160,90	£ 71.975,80
20		∞	62	£ 1.321,90	£ 81.957,80
28	95	∞	219	£ 1.002,90	£ 219.635,10
28	95	∞	219	£ 1.093,90	£ 239.564,10
20		∞	62	£ 1.241,90	£ 76.997,80
20		∞	62	£ 1.160,90	£ 71.975,80
20		∞	62	£ 1.160,90	£ 71.975,80
20		∞	62	£ 1.321,90	£ 81.957,80
28	95	∞	219	£ 1.002,90	£ 219.635,10
28	95	∞	219	£ 1.093,90	£ 239.564,10
20		∞	62	£ 1.241,90	£ 76.997,80
20		∞	62	£ 1.160,90	£ 71.975,80
20		∞	62	£ 1.160,90	£ 71.975,80
20		∞	62	£ 1.321,90	£ 81.957,80
28	95	∞	219	£ 1.002,90	£ 219.635,10
28	95	∞	219	£ 1.093,90	£ 239.564,10
20		∞	62	£ 1.241,90	£ 76.997,80
20		∞	62	£ 1.160,90	£ 71.975,80
20		∞	62	£ 1.160,90	£ 71.975,80
20		∞	62	£ 1.321,90	£ 81.957,80
28	95	∞	219	£ 1.002,90	£ 219.635,10
28	95	∞	219	£ 1.093,90	£ 239.564,10
20		∞	62	£ 1.241,90	£ 76.997,80
20		∞	62	£ 1.160,90	£ 71.975,80
20		∞	62	£ 1.160,90	£ 71.975,80
20		∞	62	£ 1.321,90	£ 81.957,80
28	95	∞	219	£ 1.002,90	£ 219.635,10
28	95	∞	219	£ 1.093,90	£ 239.564,10
20		∞	62	£ 1.241,90	£ 76.997,80
20		∞	62	£ 1.160,90	£ 71.975,80
20		∞	62	£ 1.160,90	£ 71.975,80
20		∞	62	£ 1.241,90	£ 76.997,80
28	95	∞	219	£ 1.002,90	£ 219.635,10
28	95	∞	219	£ 1.002,90	£ 219.635,10
20		∞	62	£ 1.241,90	£ 76.997,80
20		∞	62	£ 1.160,90	£ 71.975,80
20		∞	62	£ 1.160,90	£ 71.975,80
20		∞	62	£ 1.241,90	£ 76.997,80
28	95	∞	219	£ 1.002,90	£ 219.635,10
28	95	∞	219	£ 1.002,90	£ 219.635,10
20		∞	62	£ 1.321,90	£ 81.957,80
20		∞	62	£ 1.160,90	£ 71.975,80
20		∞	62	£ 1.160,90	£ 71.975,80
20		∞	62	£ 1.241,90	£ 76.997,80
28	95	∞	219	£ 1.093,90	£ 239.564,10



North Cyprus C21

4 sudionika

added it me in 10:00:07, forget it. I will contact them tomorrow. And as soon as possible I will start talking with them

17:39

07 11 2022

My dear brother really dont worry, I hope you resolved all issues in Istanbul, Ankara and Bodrum. Yes, no problem today or tomorrow no problem... Dont worry about Ali Kemal he knows you are busy 😊

6:26

10 11 2022



02:06

15:12

Darius



02:10

17:12

9:12 PM



Jani

Active 16 minutes ago



you give him?

We are all same from C21 we just moved to a new company that made by us

Do you have any news what sinisa is doing on the island



He is trying to open a company

We paid all the event costs and he said to the people that he paid it

And also he told us he paid all flights cost of the comers

Which we don't believe it

And the 4 sales i checked on the system was up prices

Up to 30% from the real price

Is he working alone now or does he really work with Eral



Thars why Jure was in Israel probably

It was yours con, .ion



Aa



**Jani**  
Active 16 minutes ago

We helped him too much and he did this to us

It's all good

Does c21 has to pay him anything

We still didn't lose anything

Because he shoud give me back 350k

You replied to Jani

Does c21 has to pay him anything

Yes for the 4 sales

Thats 200k

No

No no no

Not more than £45k

Great

How many units all together did he sell

17:00

7G

Khaled Belfas

In Austria it's 16.55

How long we'll need you think?

If it is ok for you

I can call u now

it may take 20 to 30 mins

Partners...EN.docx

91 KB

Better tomorrow morning bro

Khaled Belfas

Datennachricht  
DOCX

I talked with Sinisa that i will send you a direct contract

Du  
Better tomorrow morning bro

ok at 9:00 ok?

Neue Nachricht eingeben



## RESERVATION / DEPOSIT AGREEMENT

Date: 28 / 12 / 2022

Between;

**The Vendor: MSN PROPERTY LTD.** which is registered at the TRNC Registrar of Companies, with MŞ number 22693 and with the address of Şehit İbrahim Hasan Caddesi, Çanakkale, Gazimağusa, TRNC. (hereinafter referred to as the 'VENDOR').

AND

**The Purchaser: JURE GACNIK** holder of Passport Number: ...PB1617629 / SLOVENIJA... (hereinafter referred to as the 'Purchaser')

---

**Authorized Estate Agency: NEXTCENTURY LTD,** which is registered at the TRNC Registrar of Companies, with MŞ number 20428

---

**Details of the Property:** Studio Garden Apt. Closed Area 42 m2 / Garden Terrace 20m2 / Usage Area 62m2, Esentepe - Kyrenia

BLOCK - B No: 3 (B-3)

---

**Title Deed Information:** The Vendor is the registered freehold owner of the land located in Girne, Esentepe, with following registration details Sheet/Plan:S31-A-17-B-2-A, S31-A-17-B-1, Title Deed Registration Numbers: YENİ15683, Parsel No: 43, with the area of 25588,43m2,

---

**Total Sale Price of the Property:**

.....71,975.00 GBP.....

---

Under this agreement, the above mentioned authorized estate agency agrees to reserve the above mentioned property for the Purchaser in exchange for **4,310-GBP (Four Thousand Three Hundred and Ten British Pounds)** as non-refundable fee, from the date of signature of this agreement until the date of ...10/01/2023... and not to sell the property to another buyer within the stated period of time.

The Vendor also undertakes not to sell and/or transfer and/or sign any sale agreement with any other parties within this period.

Under this agreement, the abovementioned Purchaser has been paid **4,310-Stg** as reservation/deposit fee to Next Century Ltd, by the date of ...26/11/2022..., and sign this agreement by the date of ...28/12/2022...

The amount of **4,310- GBP (Four Thousand Three Hundred and Ten British Pounds)** paid for the reservation purposes and it will be taken into account as a part of the total amount to be paid.

The Purchaser, under the agreement, accepts and declares to have received the details and service regarding the said Property only from the NEXT CENTURY LTD authorities under legal legislation.

If the Purchaser decides not to buy the Property at the end of or during the reservation period, the amount of reservation fee will be taken as compensation fee by the Vendor. The amount of reservation fee is non-refundable.

The payment plan is attached as Form 1 to this agreement and both of the parties have already accepted the payment plan.

**The key handover date will be: ...DECEMBER 2024...**

The Purchaser has also a right to make the payments the below mentioned bank account and as soon as the Vendor will have the amount, the receipt of the amount will be sent to the email address of the Purchaser by the Vendor.

**The Bank Details of the Vendor:**

MSN PROPERTY LTD.

TÜRKİYE İŞ BANKASI, İSKELE – KKTC

IBAN NUMBER – GBP ACCOUNT TR85 0006 4000 0026 8090 1117 33

**The email adress & Mobile Number of the Purchaser:**

+386 51 604 099

Address: Jakceva Ulica 011 - Ljubljana

**Signed by:**

**THE VENDOR: MSN PROPERTY LTD**

**THE PURCHASER: JURE GACNIK**

**THE AUTHORIZED ESTATE AGENCY: NEXTCENTURY LTD.**

**Witness 1:**

**Witness 2:**

BUYER : JURE GACNIK

STG / EURO RATE = 1.16

<b>BLOCK B/3 STUDIO</b>	<b>Dates</b>	<b>Sales Price + %5 VAT + £3000 ELECTRIC TRAF0</b>
Sales Price 71.975,00 GBP		£ <b>78.573,00</b>
Deposit € 5000	26.11.2022	£ <b>4.310,00</b>
35%	10.01.2023	£ <b>23.190,00</b>
55%		£ <b>43.216,00</b>
13,750%	10.06.2023	£ <b>10.804,00</b>
13,750%	10.12.2023	£ <b>10.804,00</b>
13,750%	10.06.2024	£ <b>10.804,00</b>
13,750%	10.12.2024	£ <b>10.804,00</b>
10%		£ <b>7.857,00</b>
10%	10.06.2025	£ <b>7.857,00</b>
100%	Total	£ <b>78.573,00</b>



3

Sviđa mi se

Komentiraj

Podijeli



**Khaled Belfas**



Jučer u 12:57

The beginning of the new era 🤝💎



Khaled Belfas i 12 drugih

Sviđa mi se

Komentiraj



**Khaled Belfas**



25. kol u 20:33



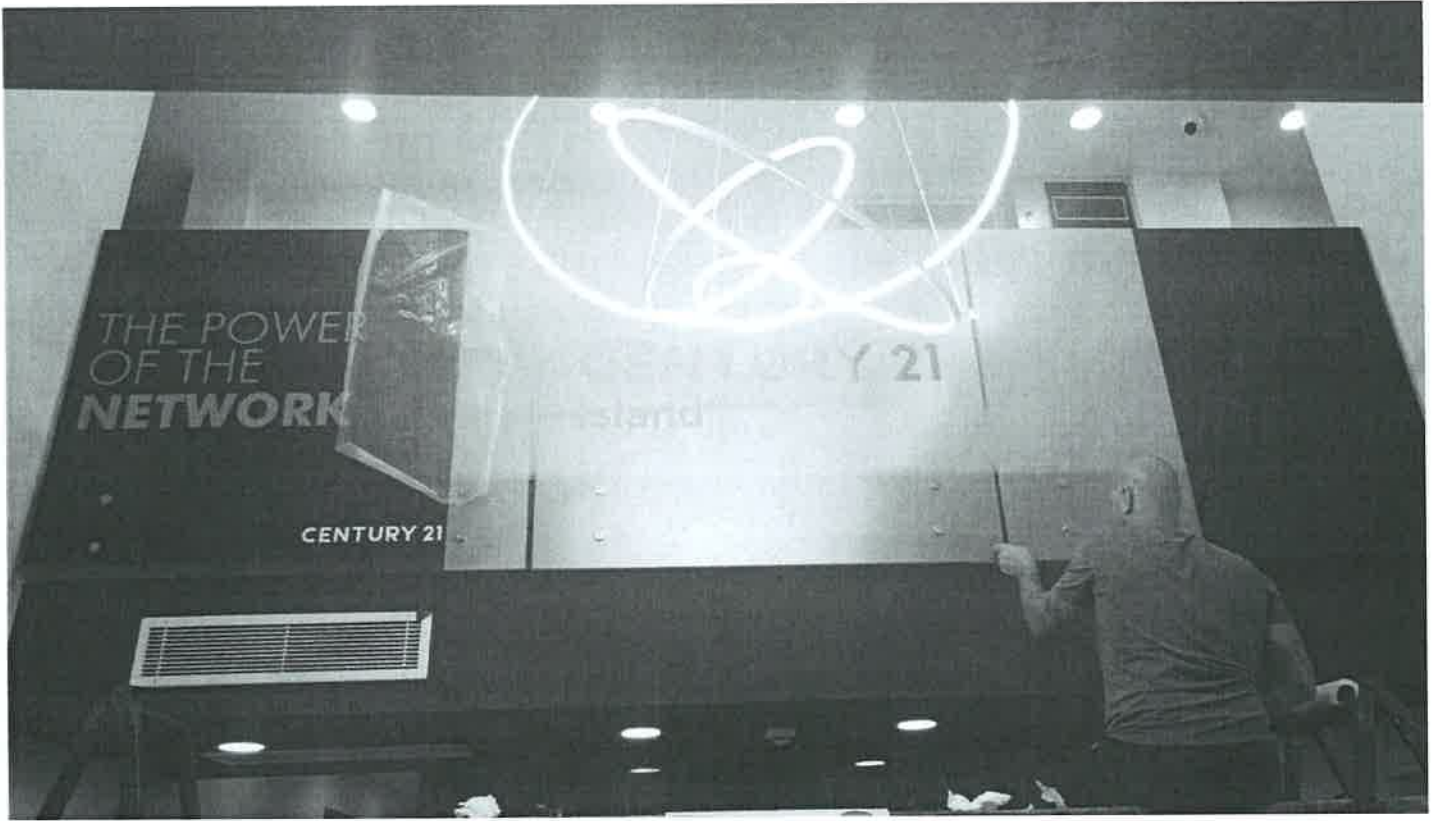



Jani

Active 16 minutes ago



For organisation and rooms

You replied to Jani

For organisation and rooms

No way

We made it free



Yes but he is charging that to customers 250 eur

We pay for it



He was always saying that he is paying for that

No way

That he pays from 30-40k a month for that



...

Wtf

He is laying everybody it looms like that



Looks



Aa





Jani

Active 16 minutes ago



He wouldn't keep working after everything happened

Like 100% must know about this

Because he didn't text me nothing

Maybe because he got some other story



Why you all left

You replied to Jani

Maybe because he got some other story

What story

You replied to Jani

Why you all left

We left because of a problem between the partners

Of Century 21

They are apart

That why we decide to move on to a new company



I heard a rumor that they are apart



Aa







 **Mustafa Tezel** Century 21 Island ... ✕  
Prije 4 h · 🌐

 **Dronebook** je na lokaciji **Kaplica, Famagusta, Cyprus.** • Prati  
Prije 5 h · Kaplica, Famagusta, Cyprus · 🌐

Kaplica/Davlos 📷  
#photo #cyprus #kibris #kaplica #drone

Prijevod nije dostupan  
Pogledaj prijevod





Jaroslav Široký

last seen today at 4:44 PM



offer in main real estate server here. I should offer something else.

4:33 PM

It's ok no problems 4:36 PM ✓✓



Homes for Sale and Rent in Cyprus - Century 21 Island

c21island.com

so from you offer please send to mail links to like 4-6 flats, that I should offer .

<https://c21island.com/en/>

4:39 PM

<https://cyprusestates.net/>

4:39 PM

and I found, how we make contract. One will be for us - C21, Sinisa, me, and one be for tax office - C21 and me. This is normal.

Many companies do that 😊

4:40 PM



0:07

4:41 PM ✓✓

Yes, ok, no problems 4:44 PM

Jaroslav Široký

and I found, how we make contract. One will be for us - C21, Sinisa, me, and one be for tax office - C21 and me. This is normal. Many ...

Ok contract Sinisa

5:07 PM ✓✓

He can do it 5:07 PM ✓✓



Message



